



Canyon



The Canyon collection is a departure from the traditional sofa. On the one hand, Canyon has an elegant profile and clean lines; on the other, the Canyon uses novel construction techniques that become part of the aesthetic design. This marriage of form and function results in a lightness of appearance and weight while maintaining rigid strength, durability and longevity. The removable cover allows for a piece to be cleaned or replaced.

Canyon modular seating features almost unlimited variations of different components, allowing for variations of a piece between an ottoman, chair, sofa sizes or chaise bed.



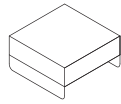

Ottoman CAN000
L 88cm D 88cm H 38cm
L 34½" D 34½" H 15"

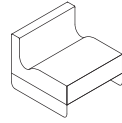

Chair CAN100
L 88cm D 88cm H 60cm
L 34½" D 34½" H 23½"

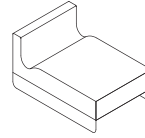

Chaise CAN15C
L 88cm D 131cm H 60cm
L 34½" D 51½" H 23½"

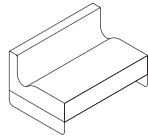

Sofa CAN150
L 131cm D 88cm H 60cm
L 51½" D 34½" H 23½"

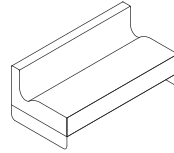

Sofa CAN200
L 174cm D 88cm H 60cm
L 69" D 34½" H 23½"

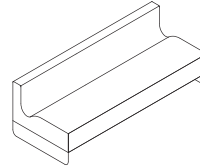

Sofa CAN250
L 219cm D 88cm H 60cm
L 86¼" D 34½" H 23½"

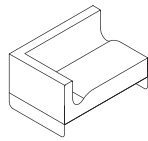

Sofa w/ arm* CAN15L/R
L 131cm D 88cm H 60cm
L 51½" D 34½" H 23½"

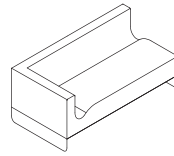

Sofa w/ arm* CAN20L/R
L 174cm D 88cm H 60cm
L 69" D 34½" H 23½"

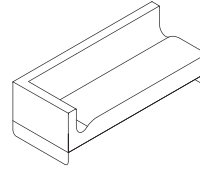

Sofa w/ arm* CAN25L/R
L 219cm D 88cm H 60cm
L 86¼" D 34½" H 23½"

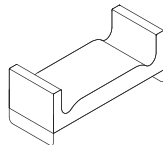

Daybed 2 CANDBE
L 174cm D 70cm H 60cm
L 69" D 27½" H 23½"

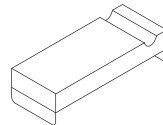

Daybed CANDBD
L 174cm D 70cm H 38cm
L 69" D 27½" H 15"



Cushion CANBCU
L 70cm D 50cm H 17cm
L 27½" D 19¾" H 6¾"



Bolster CANBOL
L 70cm D 20cm H 20cm
L 28" D 8" H 8"

*Left arm shown. Please specify L for left and R for right armed sofas.



Canyon incorporates new construction processes and manufacturing procedures. Conventional sofas are assembled using wood frames onto which springs can be mounted and fabric stapled. In contrast, Canyon combines a welded steel frame with contoured foam, woven synthetic strapping and removable or replaceable covers.

Canyon's welded steel frame allows it to endure longer than conventional wood framed seating. The steel frame is designed to have the same structural integrity when combined with multiple pieces. A woven suspension system used in the automotive industry is uniquely attached to the steel frame, adding superior support while creating a lighter appearance.